



**ESTP50N~200N**



**ESTP300N**

## ▲ Operating Conditions

1. Ambient temperature: Max.40°C.
2. Liquid temperature: 2~60°C.
3. Working Pressure: Max.3.0 bar.
4. The noise level is around 60~65 decibel.

## ▲ Applications

Re-circulation and filtration systems, Jetted bath tubs, spa pools, swimming pools, massage stations, cleaning system , water circulation for aquiculture .

## ▲ Features

1. The motor shaft do not come into contact with water.
2. Pump casing, casing cover & impeller are made of highly reinforced plastic. The wetted parts are no rusty.
3. Equipped with the strainer inside pump body for less cleaning and easy maintenance.

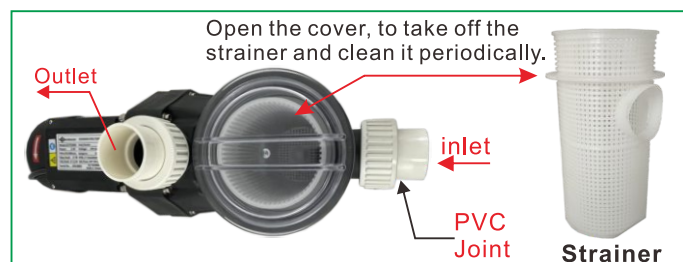

## ▲ Motor Spec.

1. 2-pole induction motor.  
Single-phase 220~240V/50Hz.  
Three-phase 380~415V/50Hz  
60Hz motor is available upon request.
2. Single-phase with overload protector.  
.capacitor inside terminal box.
3. Insulation class F.
4. Protection IPX5.
5. Continuous duty is acceptable.

## ▲ Main parts & Materials

No.	Part Name	Std.Material
1.	Pump cover	PP-G20
2.	Impeller	PA6+GF30
3.	Mechanical seal	CA/CE/NBR
4.	Shaft	SUS420
5.	Pump casing	PP-G20
6.	Front cover	PP-G20
7.	Motor shell	Aluminum alloy
	Motor coil	Copper

### Performance Curves

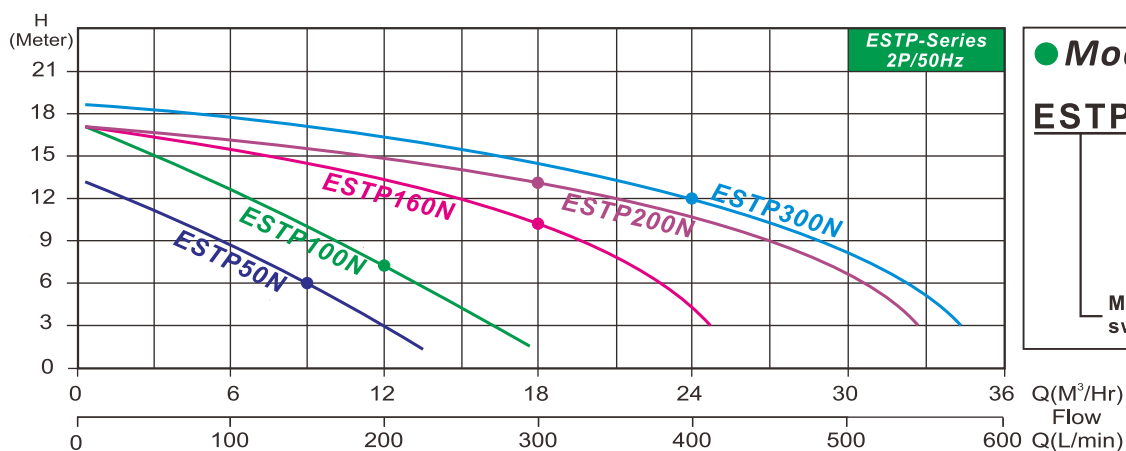

### Model Code

#### ESTP200NT

Without T:1 Phase  
T:3 phase  
New generation II  
50:0.5HP;160:1.6HP  
100:1HP;300:3HP  
Model name of swimming pool pump

### Specification & Dimensions

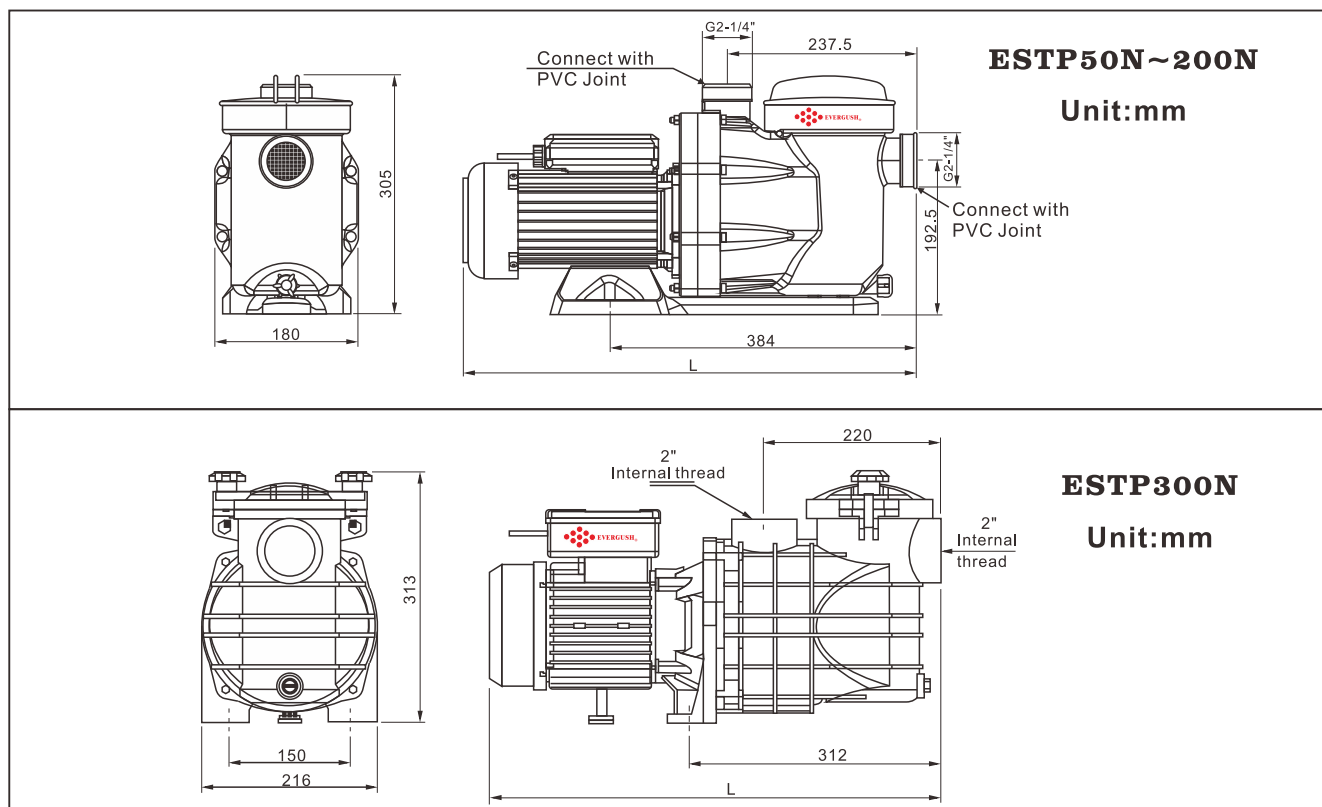

Model	Power		Pole	Phase/ Voltage	Inlet/Outlet		Max. suction head	Max.Head	Max.Flow	Gross weight	L
	KW	HP				mm	M	M	L/min	KG	mm
ESTP50N	0.37	0.5	2	1Ø 220~240V	PVC Joint	48.5	3.0	13	220	7.2	528
ESTP50NT				3Ø 380~415V							
ESTP100N	0.75	1	2	1Ø 220~240V	PVC Joint	48.5	3.5	17	320	10.4	528
ESTP100NT				3Ø 380~415V							
ESTP160N	1.2	1.6	2	1Ø 220~240V	PVC Joint	48.5	3.5	17	450	11.9	556
ESTP160NT				3Ø 380~415V							
ESTP200N	1.5	2	2	1Ø 220~240V	PVC Joint	48.5	4.0	17	560	13.8	571
ESTP200NT				3Ø 380~415V							
ESTP300N	2.2	3	2	1Ø 220~240V	Internal Thread	50	6.0	18.5	580	23	587
ESTP300NT				3Ø 380~415V							